



FIRESTOP CENTRE

Authorised New Zealand Distributor
Ph (09) 483 4000 www.firestopcentre.co.nz

Allproof Drop-In Fire Collar Cables (Power and Data) in CLT Floor (from 110mm)



BRANZ Appraisal 1008
Technical Manual - Electrical Pg 17
AS1530.4-2014 AS4072.1-2005

System ID# FC498

Products	Allproof Drop-In Fire Collar
Application	Fire stopping of cables in CLT floor
Construction	Minimum floor thickness of 110mm

Fire Classification:

See **Page 2** for details of the following:-

Cables - TPS, CAT6 Data, Mains and Earth cables in various combinations

Up to FRR -/60/60

INSTALLATION INSTRUCTIONS:

1. Core drill hole to specified diameter to suit service size.
2. Install drop-in fire collar fixing with two 25mm pan head screws.
3. Ensure collar on underside of floor is exposed no greater than 20mm.
4. Seal gaps between floor/collar and collar/service with a minimum 5mm depth of Allproof MAS310 sealant, using a backing rod if annular space greater than 4mm.

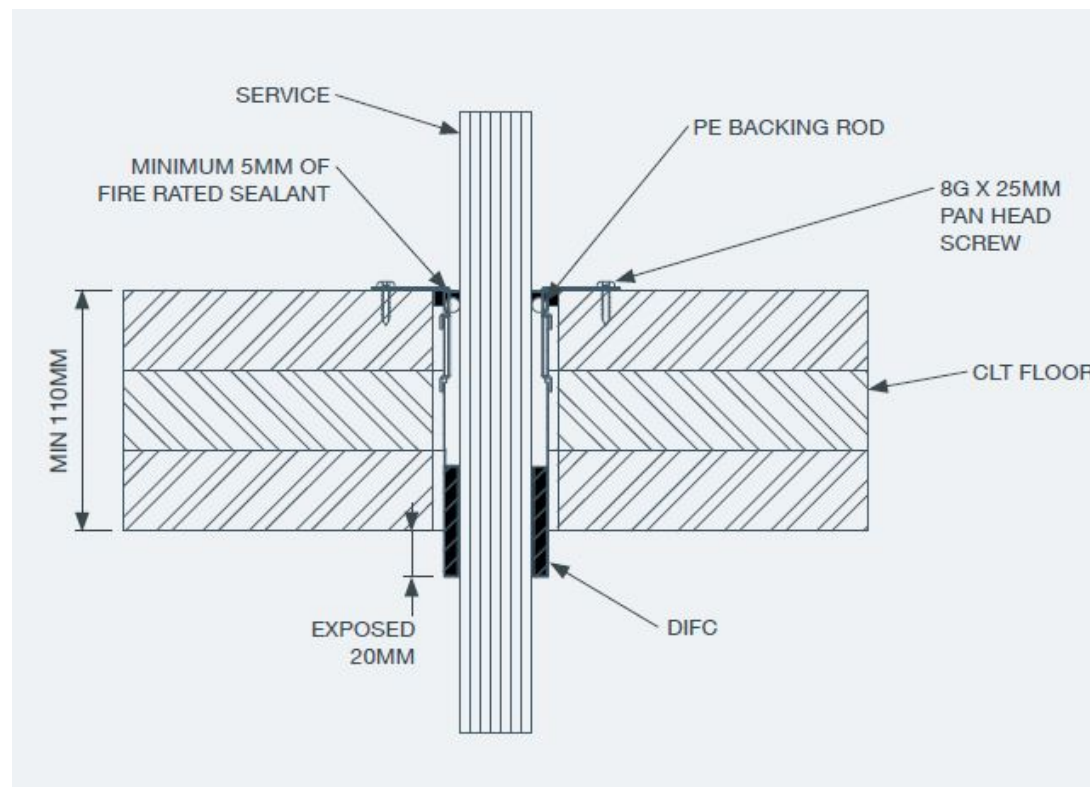

BRANZ Appraised
Appraisal No.1088 [2019]

As a part of our policy of on-going product development and testing, we reserve the right to modify, alter or change product specifications without giving notice. All information contained in this document is given in good faith and is provided for guidance only. Any drawings provided are for illustrative purposes only. As Firestop Centre has no control over the methods or competence of installation and of prevailing site conditions, no warranties, expressed or implied, is intended to be given as to the actual performance of the product mentioned or referred to herein and no liability whatsoever will be accepted for any loss, damage or injury arising from the use of the information given.

For all technical details on the products specified please refer to the technical data sheets that can be found on www.firestopcentre.co.nz

Signed and approved:

ALLPROOF

INDUSTRIES

Allproof Industries Ltd
17 Bay Park Place
Beach Haven, AK 0626

Sheet size: A4	Drawn date & no: 28/5/25
Scale: NTS	Drawn by: G.P

CROSS LAMINATED TIMBER (CLT) FLOOR TEST RESULTS:

DESCRIPTION	TIMBER DEPTH	PRODUCT CODE	PENETRATION HOLE SIZE (MM)	FLOOR FRL*	REPORT NUMBER
CABLES					
1x TPS Cable	110	DIFC32	57	-/60/60	148131
7x TPS Cables	110	DIFC32	57	-/60/45	146208
1x CAT6 Data Cable	110	DIFC32	57	-/60/60	148131
1 x 16mm Mains Cable & 1x 10mm Earth Cable	110	DIFC32	57	-/60/30	148131
1x 25mm Mains Cable & 1x 10mm Earth Cable	110	DIFC32	57	-/60/45	146208

Fixing: Collars tested using 8G X 25mm Pan Head Screw.
For installations resulting in an annular gap of 4mm or greater insert PE backing rod prior to fire rated sealant.

CROSS LAMINATED TIMBER INSTALLATION DETAILS:

